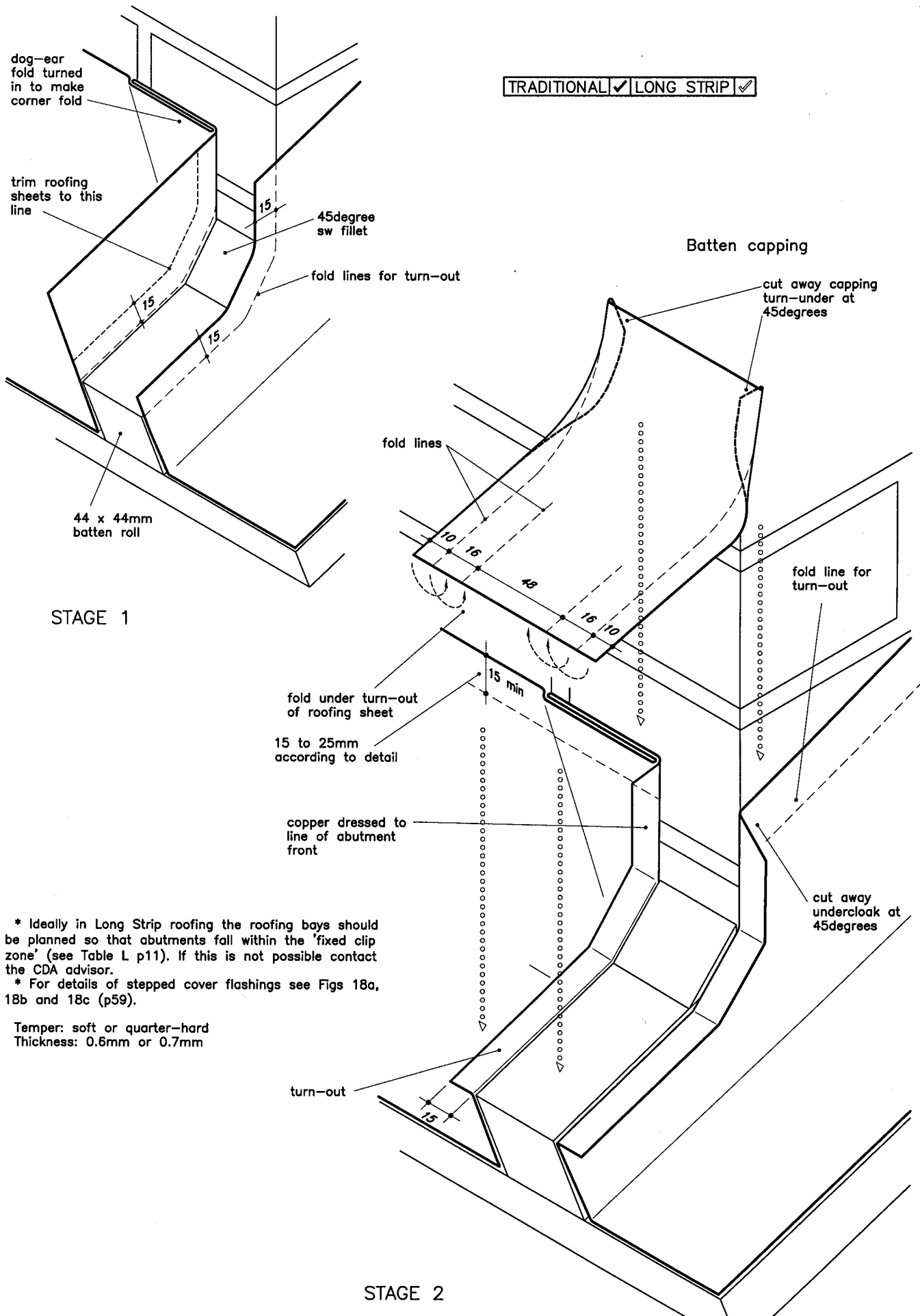

Fig 45 Batten roll at external corner



\* Ideally in Long Strip roofing the roofing bays should be planned so that abutments fall within the 'fixed clip zone' (see Table L p11). If this is not possible contact the CDA advisor.  
 \* For details of stepped cover flashings see Figs 18a, 18b and 18c (p59).

Temper: soft or quarter-hard  
 Thickness: 0.6mm or 0.7mm

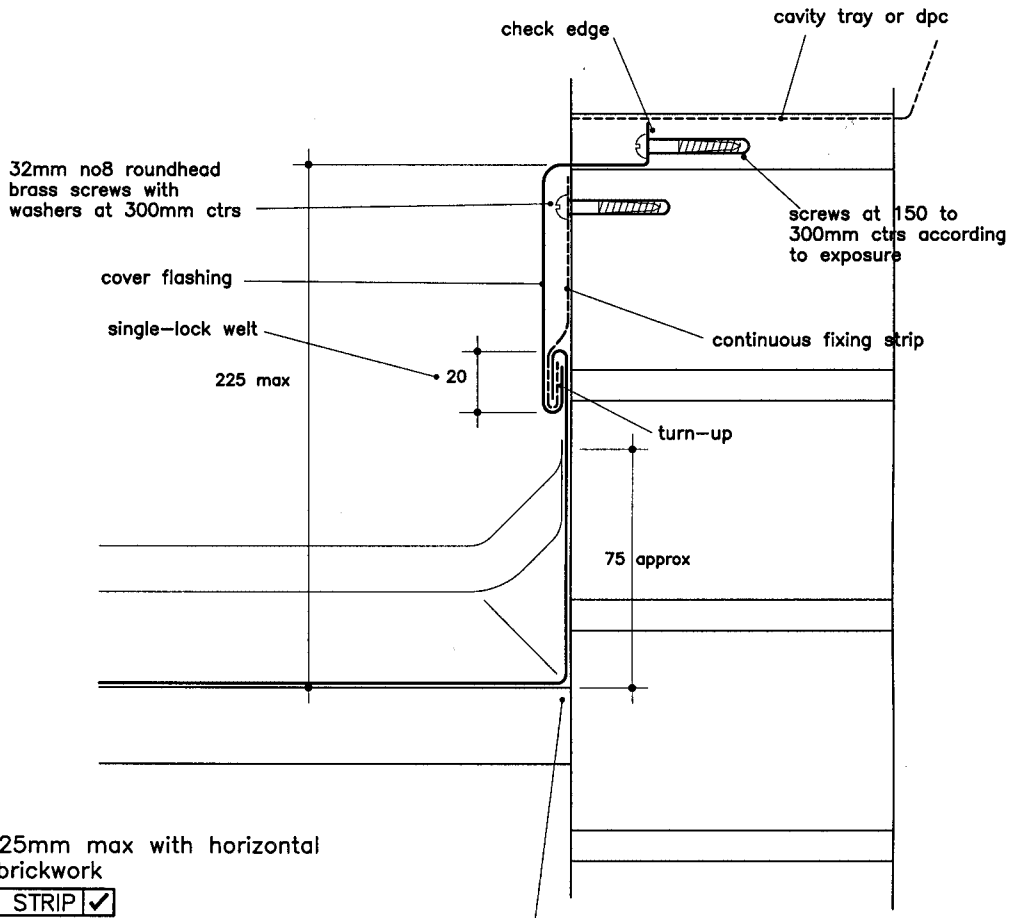
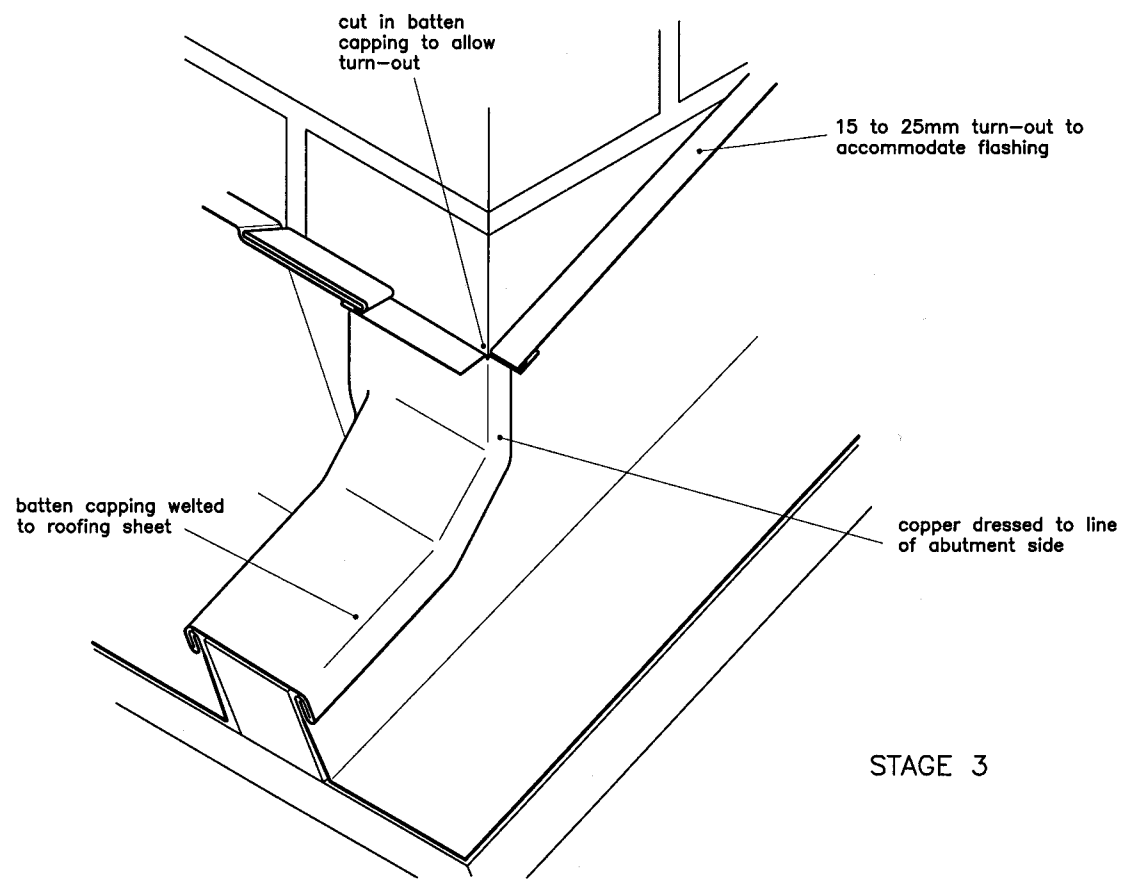

Fig 45a  
 Vertical upstand 225mm max with horizontal  
 cover flashing to brickwork

TRADITIONAL ✓ LONG STRIP ✓

5mm movement gap in Traditional  
 10mm movement gap in Long Strip



STAGE 3